

LACEFIELD & BROCK  
DB. 294, PG. 676

N 55°51'45" E  
19.42'

0.4 MILES TO  
VANARSDILL  
ROAD

N 59°33'24" E  
36.49'

N 63°05'38" E  
218.77'

N 32°32'58" E  
36.71'

01°47'33" E  
44.60'

N 06°15'48" W  
276.48'

N 06°15'48" W  
217.52'

N 06°15'48" W  
217.52'

N 06°15'48" W  
217.52'

N 07°34'53" W  
224.78'

N 07°34'53" W  
224.78'

S 11°11'03" E  
496.76'

80' B/L

TRACT 1  
2.93 ACRES

N 89°30'35" W  
330.07'

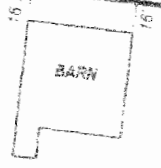

S 11°11'03" E  
357.78'

TRACT 2  
3.13 ACRES



GRAVEL DRIVE

S 77°03'50" W  
354.97'

S 11°11'03" E  
357.78'

C/L NORFOLK SOUTHERN RAILROAD

COLE & BREWER  
DB. 228, PG. 492

2.51 Acres

C/L JAC

GARRIOTT ROAD 40' R.O.W.  
 54°29' W  
 334.11'  
 25' U.E.  
 80' B/L

BASIS FOR BEARINGS  
 N 16°54'29" W

7.56 ACRES  
 REMAINING

211.07'  
 S 11°11'03" E  
 116.41'

R=5679.47'  
 L=246.01'  
 LC=245.99'  
 LCB=S 09°56'35" E

360.00'

N 16°54'29" W

R=5679.47'  
 L=467.51'  
 LC=467.37'  
 LCB=S 06°20'40" E

421.00'

80' B/L

R=5679.47'  
 L=1.41'  
 LC=1.41'  
 LCB=S 03°53'52" E

S 71°39'39" W  
 3.06'  
 S 28°30'11" W  
 3.51'

S 12°24'03" W  
 3.04'  
 S 75°40'24" W  
 176.76'

N 35°38'55" W  
 18.21'

N 76°08'42" W  
 15.01'

TES  
 IS NOT IN A DESIGNATED  
 AREA PER FEMA ( FEDERAL  
 NAGEMENT AGENCY )  
 050 B ZONE X  
 IVE: OCTOBER 18, 1988  
 IARANTEE THAT FLOODING  
 R.

CERTIF  
 I / WE H  
 PROPEI  
 THIS PL  
 ESTABL  
 MEDICA  
 PUBLIC  
 OWNER  
 OWNER

INC.

AD  
 10342

-5534  
 3443

JOB NO.	05-1108A
FIELD COMPLETION DATE:	8-23-05
PLAT COMPLETION DATE:	8-26-05
DRAWN BY:	GAIL HOLMAN

CE  
 TH  
 OF  
 CH